

## AIR-O-MATIC RAC Exploded View

**Factory Model:** AOMC18DPE17  
**Product Code:** AOM11104210000086PE  
**Power Supply:** 230V

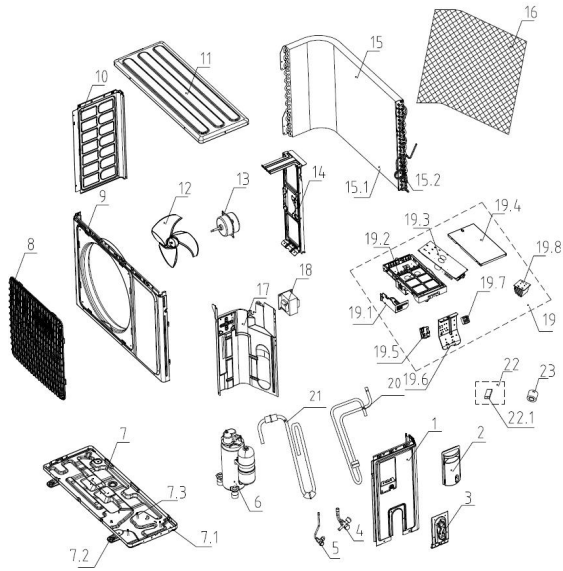

No.	Part Name	Quantity	BOM Code
1	Right Side Board	1	AOM11321007000291PE
2	E-Parts Cover	1	AOM11321008000014PE
3	Valve Plate	1	AOM11321031000027PE
4	Stop Valve	1	AOM11325042000030PE
5	Stop Valve	1	AOM11225517000036PE
6	Compressor	1	AOM11223003000292PE
7	Chassis Assembly	1	AOM11221502000464PE
7.1	Chassis	1	AOM11321014000145PE
7.2	Base Footing	2	AOM11321023000019PE
7.3	Screw Bolt	3	AOM14731005000042PE
8	Panel Grille	1	AOM11321022000215PE
9	Panel	1	AOM11321005000117PE
10	Left Side Board	1	AOM11321006000113PE
11	Top Cover	1	AOM11321009000057PE
12	Axial Flow Fan	1	AOM11320009000063PE
13	Motor	1	AOM11230005000012PE
14	Motor Support	1	AOM11321002000040PE
15	Condenser Assembly	1	AOM11224004001279PE
15.1	Condenser Assembly	1	AOM11224006000478PE
15.2	Capillary Assembly	1	AOM11225506001798PE
16	Cardboard	1	AOM11332009000046PE
17	Partition Board	1	AOM11321025000059PE
18	Reactor	1	AOM11330034000020PE
19	Main Controller	1	AOM11222004000523PE
19.2	Control Box	1	AOM11320057000069PE
19.3	PCB	1	AOM11222031000943PE
19.4	Control Box Cover	1	AOM11320058000057PE
19.6	E-parts Bracket	1	AOM11321015000071PE
19.7	Terminal Board	1	AOM11330037000157PE
19.8	Radiator	1	AOM11329031000031PE
19.8	Radiator	1	AOM11329031000067PE
20	Discharge Pipe Assembly	1	AOM11325020001188PE
20	Discharge Pipe Assembly	1	AOM11225505000722PE
21	Suction Pipe Assembly	1	AOM11225504000643PE
22	Accessories	1	AOM11219005000166PE
22.1	Putty	1	AOM14618079000002PE
23	Tape	1	AOM11320022000016PE

**Note:** The information presented is for the use of Professional HVAC Technicians. Subject to change without notice. Prices are subject to Shipping & Handling charges.